

| VERSIONI CON DETERGENTE | Ugello | Targhetta |
|------------------------------------|--------|------------------|
| Portata minore/uguale dia 14 l/min | Ø2 | UNICONTROL 0 S&G |
| Portata minore/uguale dia 21 l/min | Ø2.2 | UNICONTROL 1 S&G |
| Portata minore/uguale dia 30 l/min | Ø2.5 | UNICONTROL 2 S&G |

Modelli con iniettore detergente Model with chemical injector

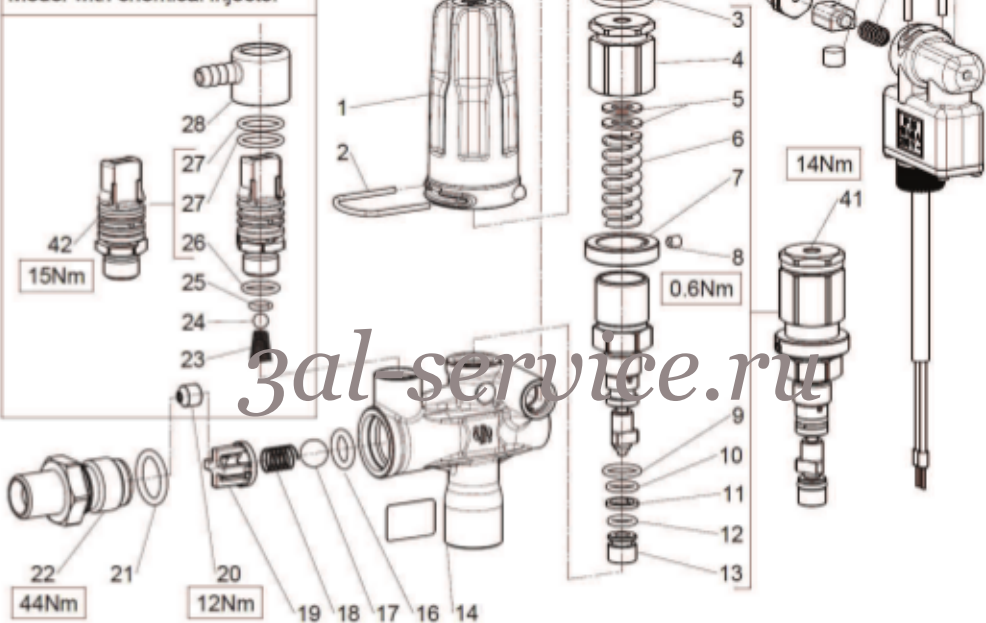

| Pos | Cod. | Descrizione - Description | Kit | Nr |
|-----|----------|--------------------------------|-----|----|
| 1 | 36350651 | POMOLO | 1 | 1 |
| 2 | 10084666 | FORCELLA | 1 | 1 |
| 3 | 90384500 | OR 18.72x2.62 | 1 | 1 |
| 4 | 36348170 | REGISTRO PRESSIONE | 1 | 1 |
| 5 | 36348851 | RONDELLA DI SCORRIMENTO | 1 | 1 |
| 6 | 94739500 | MOLLA DM 11.3x34.5 | 1 | 1 |
| 7 | 36347770 | GHIERA DI MAX PRESSIONE | 1 | 1 |
| 8 | 99126700 | VITE M4x5 UNI 5929 INOX | 1 | 1 |
| 9 | 90358700 | OR 11.11x1.78 | 1 | 1 |
| 10 | 90358100 | OR 8.73x1.78 | 1 | 1 |
| 11 | 90503800 | ANELLO ANTIEST. D.9x12x1.5 | 1 | 1 |
| 12 | 90357800 | OR 7.66x1.78 | 2 | 1 |
| 13 | 36348366 | SEDE E2 | 1 | 1 |
| 14 | 36349941 | CORPO UNICONTROL S&G - CHIMJET | 1 | 1 |
| 14 | 36351441 | CORPO UNICONTROL S&G | 1 | 1 |
| 16 | 90382300 | OR 9.92x2.62 | 1 | 1 |
| 17 | 97483800 | SFERA 13/31 | 1 | 1 |
| 18 | 94735500 | MOLLA DM. 8.5x12 INOX | 1 | 1 |
| 19 | 36310451 | GUIDA VALVOLA | 1 | 1 |
| 20 | 10079566 | UGELLO PER INIETTORE Ø2 | 1 | 1 |
| 20 | 10079966 | UGELLO PER INIETTORE Ø2.2 | 1 | 1 |
| 20 | 10084966 | UGELLO PER INIETTORE Ø2.5 | 1 | 1 |
| 21 | 90383900 | OR D. 15.88x2.62 | 1 | 1 |
| 22 | 36347970 | NIPPLO G3/8-M203 | 1 | 1 |
| 22 | 36348870 | NIPPLO M22X1.5 - Ø3 | 1 | 1 |
| 22 | 36348970 | NIPPLO G3/8-F-Ø3 | 1 | 1 |

| | | | | |
|----|----------|--------------------------------|---|---|
| 23 | 94821700 | MOLLA CONICA Ø4.3/7.3x11 | 1 | 1 |
| 24 | 97478200 | SFERA D.7/32" | 1 | 1 |
| 25 | 90357300 | OR 5.28x1.78 | 2 | 1 |
| 26 | 90358500 | OR 10.82x1.78 | 1 | 1 |
| 27 | 90359100 | OR 14x1.78 | 2 | 1 |
| 28 | 36023551 | PORTAGOMMA ORIENTABILE | 1 | 1 |
| 29 | 90500400 | ANELLO ANTIEST. D.3.2X8X1.5 | 1 | 1 |
| 30 | 90359600 | OR 2.9x1.78 | 1 | 1 |
| 31 | 36351466 | PISTONCINO TOTALSTOP | 1 | 1 |
| 32 | 90502100 | ANELLO ANTIEST. D.6.1X9X1.5 | 1 | 1 |
| 33 | 94733335 | MOLLA DM.8.3X16 | 2 | 1 |
| 34 | 90356200 | OR 1.78x1.78 | 1 | 1 |
| 35 | 90500000 | ANELLO ANTIEST. D.2X5X1.5 | 1 | 1 |
| 36 | 36350470 | GUIDA PISTONCINO | 1 | 1 |
| 37 | 36024051 | SLITTA PORTAMAGNETE | 1 | 1 |
| 38 | 36351500 | MAGNETE Ø8X6 | 1 | 1 |
| 39 | 10081166 | FORCELLA STOP&GO | 1 | 1 |
| 40 | 36601601 | ASSIEME STOP&GO | 1 | 1 |
| 41 | 36605401 | FRUTTO VALVOLA E2 CON SEDE | 1 | 1 |
| 42 | 36724001 | ASSIEME ASPIRAZ. DE DETERGENTE | 1 | 1 |

| Kit N° | Posizione incluse - Positions included | Nr Pcs |
|--------|--|--------|
| 278 | 16, 17, 18, 19, 21, 41 | 1 |
| 354 | 29, 30, 31, 25, 32, 33, 34, 35, 12, 36 | 1 |
| 355 | 37, 38, 33, 39, 40 | 1 |